

COMPRESSION CASTING LUGS

ONE-HOLE

- Material : High Conductivity copper per 99.9% up
- Finish(Optional): Unplating, Tin-plating & Silver-plating

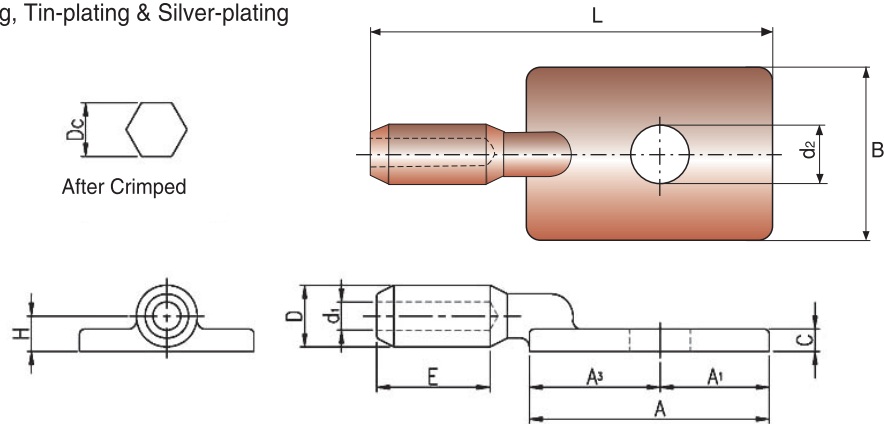

All dimensions are same as KS C2618 standard (경동 연선용 단자 C형)

Wire Range		Part No.	Stud Size	Dimension													
AWG,MCM	mm ²			D	d1		E	A	A1	A2	A3	B	C	d2	L	H	Dc
4	20,22	DCEO-0301	M12	14	+0.8 -0.2	6.4	26	55	25	-	30	40	5	14	90	8	12.1
2	35,38	DCEO-0302	M12			8.3											
2/0	50,60	DCEO-0303	M12	19		10.6	±0.3	30							94	10.5	16.4

TWO-HOLE

- Material : High Conductivity copper per 99.9% up
- Finish(Optional): Unplating, Tin-plating & Silver-plating

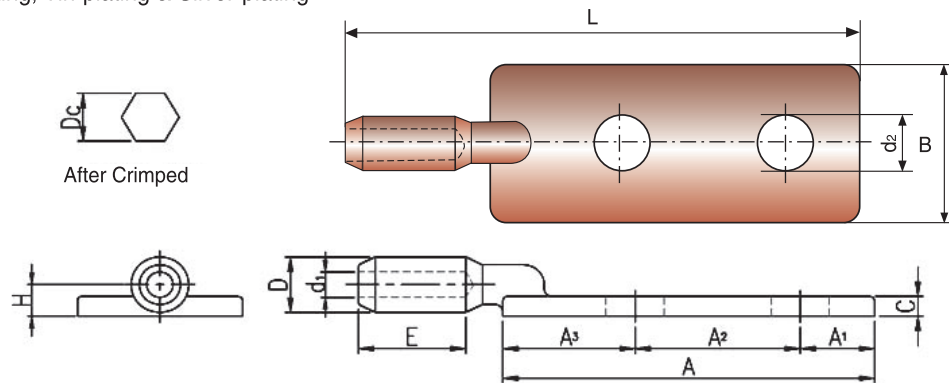

All dimensions are same as KS C2618 standard (경동 연선용 단자 C형)

Wire Range		Part No.	Stud Size	Dimension													
AWG,MCM	mm ²			D	d1		E	A	A1	A2	A3	B	C	d2	L	H	Dc
1/0	55	DCET-0301	M12	19	+0.8 -0.2	10.2	30	90	18	40	32	40	6	14	135	11	16.4
2/0	60	DCET-0302	M12			10.6											
3/0	75	DCET-0303	M12	23	+0.8 -0.2	11.7	39	95	20	40	35	50	8	14	150	13	19.9
4/0	100	DCET-0304	M12			13.6											
250MCM	120,125	DCET-0305	M12	26		15.2	44	110	25	45	10	14	170	16	25.1	14.5	22.5
300MCM	150	DCET-0306	M12	29	±0.4	16.9											
400MCM	180,185	DCET-0307	M12	32	+0.1 -0.2	18.5	53	110	25	45	10	14	180	17.5	27.7	19.5	31.1
400MCM	200	DCET-0308	M12			19.5											
500MCM	240	DCET-0309	M12	36		21	62	110	25	45	10	14	207	20.5	32.9	20.5	32.9
500MCM	250	DCET-0310	M12	38	±0.4	21.9											

COMPRESSION CASTING LUGS

FOUR-HOLE

- Material : High Conductivity copper per 99.9% up
- Finish(Optional): Unplating, Tin-plating & Silver-plating

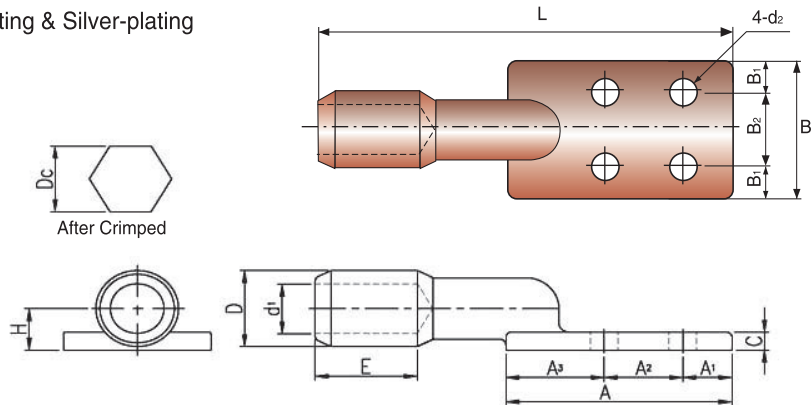

All dimensions are same as KS C2618 standard (경동 연선용 단자 C형)

Wire Range		Part No.	Stud Size	Dimension																				
AWG,MCM	mm ²			D	d1	E	A	A1	A2	A3	B	B1	B2	C	d2	L	H	Dc						
600MCM	300,325	DCEF-0301	M12	42	+0.1 -0.2	24.7	±0.4	62	115	-	40 ±0.4	50	75	17.5	40 ±0.4	10	14	212	23	36.3				
800MCM	400	DCEF-0302	M12	47		27.4		70										40	75	17.5	12	222	22.5	40.7
1000MCM	500	DCEF-0303	M12	47		30.2		70										40	75	17.5	12	222	22.5	40.7

SIX-HOLE

- Material : High Conductivity copper per 99.9% up
- Finish(Optional): Unplating, Tin-plating & Silver-plating

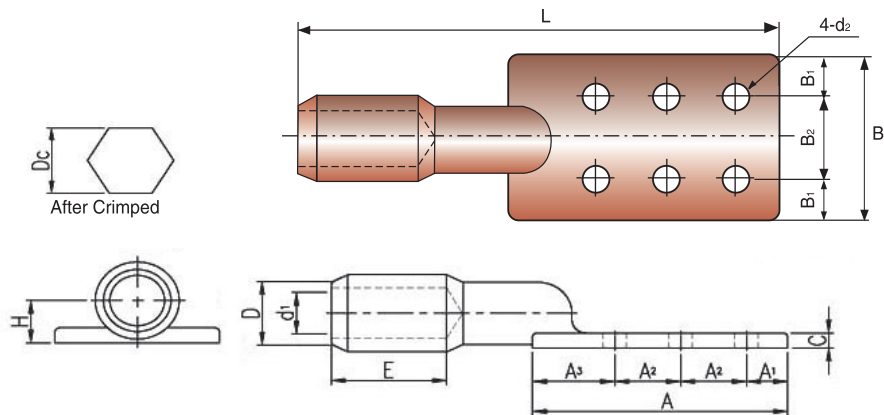

All dimensions are same as KS C2618 standard (경동 연선용 단자 C형)

Wire Range		Part No.	Stud Size	Dimension																							
AWG,MCM	mm ²			D	d1	E	A	A1	A2	A3	B	B1	B2	C	d2	L	H	Dc									
1250MCM	600,630	DCES-0301	M16	51	+0.1 -0.2	33.3	±0.4	70	155	25	40±0.4	50	75	17.5	40±0.4	12	18	262	28	44.1							
1500MCM	725	DCES-0302	M16	56		36.7		90										190	30	50±0.6	60	100	25	50±0.6	325	30.5	48.4
1500MCM	800	DCES-0303	M16	56		39.3		90										190	30	50±0.6	60	100	25	50±0.6	325	30.5	48.4
2000MCM	1000	DCES-0304	M16	64		43.2		100										190	30	50±0.6	60	100	25	50±0.6	335	34.5	55.4